



## Wera tools for better working results.

Together with its more than 600 employees and in just over 70 years, the company with its main office at Wuppertal, Germany has developed into one of the world's leading manufacturers of quality wrenches and screwdrivers for the professional.

Developments and production is state-of-the-art and fully incorporates the most recent know-how in the fields of metallurgy and process technology. The processor-oriented quality assurance system ensures for a multiple level of security and exceeds the requirements of DIN EN 9001. The consequence of this is that the rate of claims is close to zero.



**Wera Tools Inc.**  
**3-730 South Service Road**  
**Stoney Creek, Ontario, L8E-5S7**  
**Canada**  
**Fon +1 / 905 / 643 6600**  
**Fax +1 / 877 / 650 9372**  
**info@weratools.com**  
**www.weratools.com**

USA 05500306001 · 02.08 · Printed in Germany



**ZYKLOP**  
**will take you**  
**beyond the limit!**





## The new ratchet Zyklop from Wera – the specialist for screwdrivers and fastening tools

No mechanic should be without a good ratchet – a good ratchet is the heart and soul of every toolbox.

Wera combines the advantages of five ratchet types in just one tool.

- fine-tooth ratchet**
- + flex head ratchet**
- + angle ratchet**
- + nut fixing ratchet**
- + power ratchet**

---

= **ZYKLOP**

In addition the Zyklop can also be used as a screwdriver! The Zyklop ratchet is the ideal solution for all types of work – at incredible speed, and with incredible durability.

All Zyklop products are available in 1/4", 3/8", and 1/2" drive, including sockets, extensions, and many other useful accessories.

**Faster than you think.**



## What are the Zyklop's special features?

### Fast turning work

Zyklop ratchets are really fast movers: the rotating mass design accelerates the fastening process. Think of a spinning top: simply give it a brief spin, and the top rotates on and on quickly and steadily.

The combination of rotating mass design and a free-wheel sleeve lets you turn the fastener quickly. To completely secure the fastener in the final position, switch over the lever and tighten the joint as necessary.

The same speed is available when removing fasteners as well!

### Fast connections!

The unique socket lock system makes accessory changes much faster. The ball lock secures both sockets and accessories for reliable and safe work. A quick press on the release button, and tool changes are possible in each of the 5 ratchet head positions.

The premium extensions are also fitted with a flexible locking system. With this system activated, drive handles can be secured permanently to the extension. When deactivated the system allows fast changes without manual switching.

### Not only for nuts!

The Zyklop not only handles nuts and hex screws, it can also hold a bit in the in-line or 0° position, for use as a screwdriver. At the same time the Wera Kraftform handle provides high torque, faster work, and is easy on the hands.

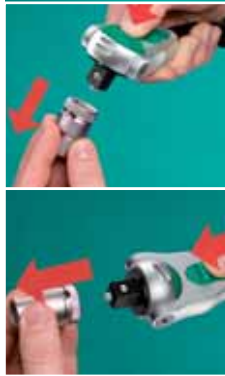



### Swivels to make life easy!

The ratchet features a swivelling head that can be released in any position by the slide switches located on both sides. This means you can work easily even in cramped or awkward spaces.

The 5 defined locking points at 0°, 15° and 90° (either left or right!) prevent the ratchet head from slipping for reliable work.



### A perfect set of teeth!

With fine-pitched teeth the reversible ratchet has a small backlash angle of only 5° - 6°. The short stroke helps you to work quickly and precisely on all installation types - clockwise or anticlockwise.



### Don't switch off - switch over!

All Zyklop ratchets feature a thumbwheel that switches quickly and easily between forward and reverse at any position, even in the in-line setting. No awkward manipulation, no lost time!



### For all hands!

The ratchet head presents an ergonomic design with finger recesses that respond perfectly to your hand and fingers for turning the head. The ratchet head lies snugly in your hand for fast work.



## Is there any more?

### The easy extension to work ...

All rigid Zyklop extensions are fitted with a freewheel sleeve. This freewheel sleeve lets you tighten and loosen screws and nuts quickly and effectively. The premium extensions are also fitted with the flexible lock system. With this system activated, drive handles can be attached permanently to the extension, preventing slipping and loss. When the system is deactivated the sockets can be attached as usual and changed in a flash.



### Nice and handy!

The Kraftform handle has been designed to fit snugly in your hand, so blisters and calluses are a thing of the past. The hard materials used for the handle facilitate fast and easy manipulation and prevent the skin from "sticking". The softer, more "anti-slip" zones facilitate greater torque transfer. This combination is unbeatable!



### Socket-to-me!

The new combination “manual and machine” sockets can be used for both manual and machine work (in most cases it is forbidden to use them with impact drivers). As a result, users don't need to have two sets of sockets.

The knurling located on the back end of the socket is ideal for manual applications. This position makes it easily accessible in every situation. In addition the groove presents a perfect mould for your fingers – for easier work. Reliable handling is also assured for work when parts are covered with oil.

### From another angle ...

The wobble extension pivots through 15° in all directions. This lets you work quickly and precisely in concealed and cramped spaces as well.

### Hard shell – soft core!

Wera attaches great importance to the product design. Accordingly, not only the ratchets themselves, but also the Zyklop socket set boxes have been designed with attractive visual appeal.

They are all manufactured from durable metal which is ideal for the workshop. The rubber feet hold them securely in place. The tools are embedded in foam so that they can be carried to and around the workplace safely and securely.

The dual colour foam insert helps you to keep track of all of the pieces quickly and reliably – missing tools are immediately recognised (tool check system).

The layout of all of the parts in the sets has been indelibly cut by laser into the lid. You can then find the tool you need quickly and easily.



## The Zyklop product range, 1/4"

8100 SA 1 Zyklop ratchet set, 1/4"-drive, metric



8100 SA 3 ratchet set, 1/4"-drive, imperial



8100 SA 2 Zyklop ratchet set, 1/4"-drive, metric



8100 SA 4 ratchet set, 1/4"-drive, imperial



## The Zyklop product range, 1/4"

8000 A Zyklop ratchet with 1/4" drive



8794 LA Zyklop extension with freewheel sleeve, long, 1/4"



8790 HMA Zyklop 1/4" socket



8789 A Zyklop sliding t-handle, 1/4"



8794 SA Zyklop extension with freewheel sleeve, short, 1/4"



8795 A Zyklop universal joint, 1/4"



8796 LA Zyklop "flexible-lock" extension with freewheel sleeve, long, 1/4"



8794 A Zyklop wobble extension, 1/4"

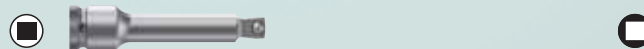

8794 SA Zyklop extension with freewheel sleeve, short, 1/4"



8784 A1 Zyklop adaptor, 1/4"





## The Zyklop product range, 3/8"

8100 SB 1 Zyklop ratchet set, 3/8"-drive, metric



8100 SB 3 Zyklop ratchet set, 3/8"-drive, imperial



8100 SB 2 Zyklop ratchet set, 3/8"-drive, metric



8100 SB 4 Zyklop ratchet set, 3/8"-drive, imperial



## The Zyklop product range, 3/8"

8000 B Zyklop ratchet with 3/8" drive



8794 LB Zyklop extension with freewheel sleeve, long, 3/8"



8790 HMB Zyklop 3/8" socket



8789 B Zyklop sliding t-handle, 3/8"



8796 SB Zyklop "flexible-lock" extension with freewheel sleeve, short, 3/8"



8795 B Zyklop universal joint, 3/8"



8796 LB Zyklop "flexible-lock" extension with freewheel sleeve, long, 3/8"



8794 B Zyklop wobble extension, 3/8"

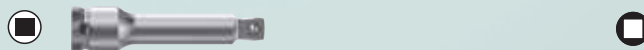

8794 SB Zyklop extension with freewheel sleeve, short, 3/8"



8784 B1 Zyklop adaptor, 3/8"



## The Zyklop product range, 1/2"

8100 SC 1 Zyklop ratchet set, 1/2"-drive, metric



8100 SC 3 Zyklop ratchet set, 1/2"-drive, imperial



8100 SC 2 Zyklop ratchet set, 1/2"-drive, metric



8100 SC 4 Zyklop ratchet set, 1/2"-drive, imperial



## The Zyklop product range, 1/2"

8000 C Zyklop ratchet with 1/2" drive



8794 LC Zyklop extension with freewheel sleeve, long, 1/2"



8790 HMC Zyklop 1/2" socket



8789 C Zyklop sliding t-handle, 1/2"



8796 SC Zyklop "flexible-lock" extension with freewheel sleeve, short, 1/2"



8795 C Zyklop universal joint, 1/2"



8796 LC Zyklop extension "flexible-lock" with freewheel sleeve, long, 1/2"



8794 C Zyklop wobble extension, 1/2"

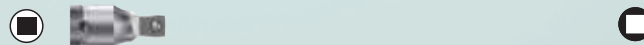

8794 SC Zyklop extension with freewheel sleeve, short, 1/2"



8784 C2 Zyklop adaptor, 1/2", 5/16"

